

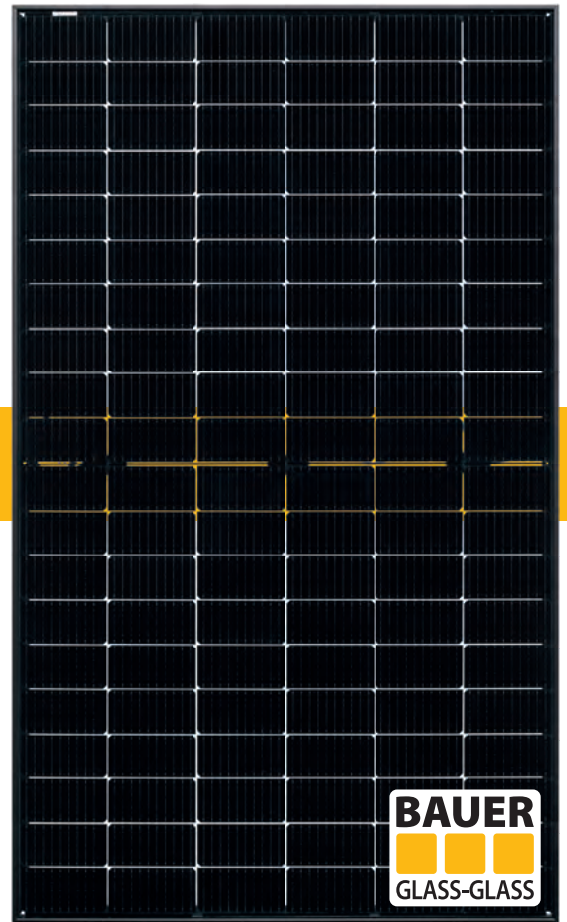

BAUER SOLARTECHNIK **PREMIUM PROTECT**

BS-120M6HBB-GG 380 - 390 W

BIFACIAL GLASS-GLASS HALF-CELL MODULE - TRANSPARENT



BAUER guarantees a minimum performance value of 87% after 30 years for the **PREMIUM PROTECT** glass-glass solar modules.

A comparison of BAUER glass-glass solar modules performance guarantee to conventional glass-foil modules according to industry standards:

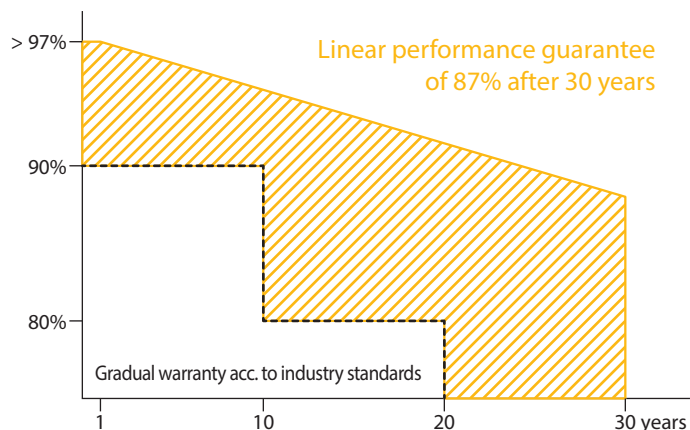

FIRE CLASS A

Maximum fire protection through double glazing according to the highest security requirements



CERTIFICATION

Constant in-house quality controls - certified several times over by accredited inspection bodies



N-TYPE BIFACIAL HALF-CELLS

Up to 30% increase in yield through bifacial cells active on both sides and a transparent backside



GERMAN GUARANTOR

If necessary, it is guaranteed that a German company takes over any claim settlements



PERFORMANCE GUARANTEE

30 year warranty and a linear performance guarantee over a period of 30 years



REINSURANCE COVERAGE

BAUER is reinsured for 12 years of the product's warranty and 25 years of the product's performance guarantee

DISTRIBUTION

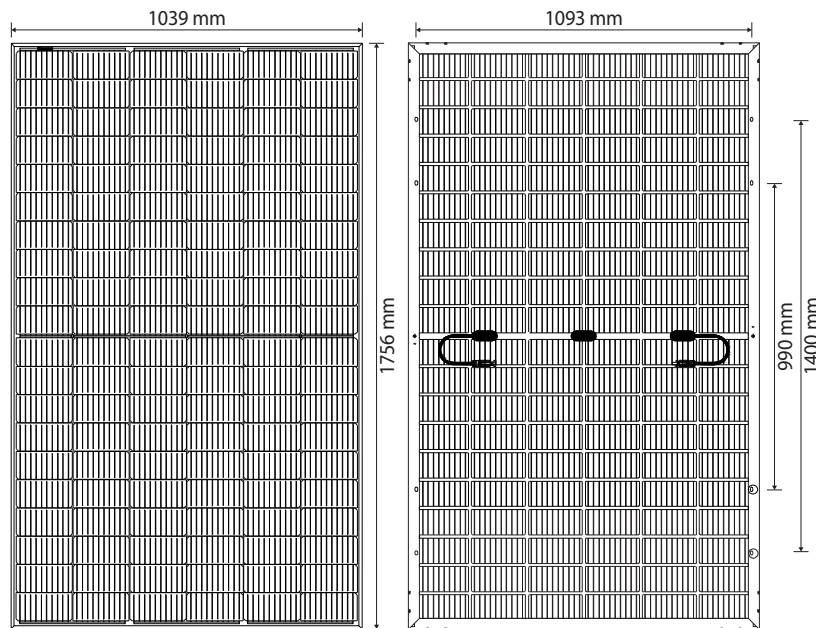

BAUER SOLARTECHNIK

PREMIUM PROTECT

BS-120M6HBB-GG 380 - 390 W

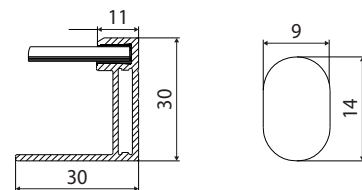

WARRANTIES¹

30 years product warranty

30 years performance guarantee

PHYSICAL SPECIFICATIONS

Module dimensions	1756 x 1039 x 30 mm
Weight	24,0 kg
Frame	Anodized aluminium alloy (black)
Frontside	Premium Protect anti-reflection glass, 2 mm
Embedding material	EVA
Backside	Premium Protect toughened glass, 2 mm
Solar cells	120 monocrystalline N-type bifacial half-cells
Bifaciality	80 % ± 5 %
Junction box(es)	IP68, 3 bypass diodes
Cable & connector	1x4 mm ² , 1200 mm, MC4 compatible

OPERATING CONDITIONS

Operating temperature	-40 to 85°C
Static load	5400 Pa (snow/wind)
Hail	Ø 25 mm at 23 m/s

CERTIFICATION

IEC 61215, IEC 61730, fire class A acc. IEC 61730-2

PACKAGING

Modules per pallet	35
Pallets/modules per truck	26/910

ELECTRICAL CHARACTERISTICS²

		BS-380-120M6HBB-GG	BS-385-120M6HBB-GG	BS-390-120M6HBB-GG
Maximum power	P _{max} (W)	380	385	390
Power output tolerance	P _{max} (%)	0 ~ +3	0 ~ +3	0 ~ +3
Open circuit voltage	V _{oc} (V)	41,80	42,00	42,20
Short circuit voltage	I _{sc} (A)	11,54	11,62	11,69
Voltage at maximum power	V _{mpp} (V)	34,90	35,10	35,30
Current at maximum power	I _{mpp} (A)	10,89	10,97	11,05
Module efficiency	η _m (%)	20,63	20,90	21,17
Bifaciality performance increase*	10 % P _{mpp} (W)	418 (+38)	423 (+38)	429 (+39)
	20 % P _{mpp} (W)	456 (+76)	462 (+77)	468 (+78)
	30 % P _{mpp} (W)	494 (+114)	500 (+115)	507 (+117)
Nominal operating cell temperature	NOCT (°C)	42 +/- 2		
Temperature coefficient of V _{oc}	T _k (V _{oc})	-0,26 %/°C		
Temperature coefficient of I _{sc}	T _k (I _{sc})	+0,046 %/°C		
Temperature coefficient of P _{mpp}	T _k (P _{mpp})	-0,32 %/°C		
Maximum system voltage DC (TÜV)	(V)	1500		
Maximum series fuse rating	(A)	25		

*depending on Albedo and irradiation conditions at installation site

¹Nominal value is specified in the written warranty conditions. A possible light-induced degradation in performance is not taken into account. ²Values under Standard Test Conditions (STC): air mass 1,5 AM, irradiance 1000 W/m², cell temperature 25°C. STC measuring tolerance: ±3 % (P_{max}), ±10 % (V_{max}, I_{mpp}, V_{oc}, I_{sc}). The beneficiary under the reinsurance policy is solely Bauer Solar GmbH. Please contact us to get information on how this insurance coverage benefits you as a customer. Note: please read the safety instructions and installation manual before using this product. Subject to change. © 2022 Bauer Solar GmbH. Effective: 09/25/22.

DISTRIBUTION